

# PRODUCT TECHNICAL DATASHEET

## BI/001PC

Brushless 

Intensive use 

High Speed 

Digital Encoder 

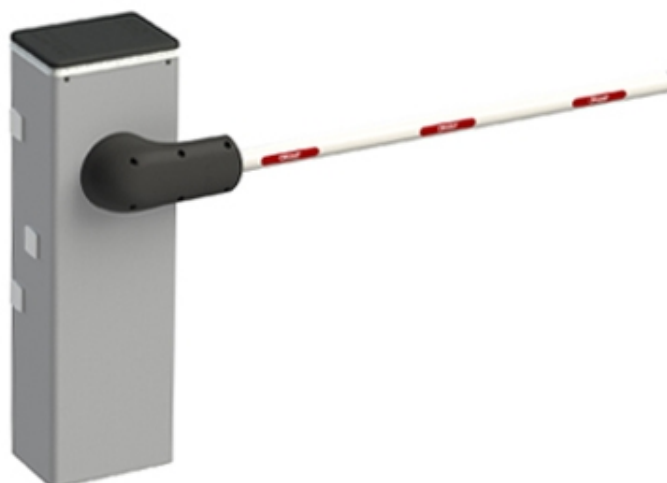

CODE	DESCRIPTION	PCS/PALLET
BI/001PC	Automatic Barrier BRUSHLESS 36V DC, rapid version, super intensive use up to 3 meters, with operator and and built in digital control panel and absolute encoder on board; parking version. Version for cylindrical boom arm BA/60/3.	6

PRODUCT TECHNICAL SPECIFICATIONS	
Barriers	Up to 3 mt long
Power line supply	230V AC - 50Hz
Motor power supply	36V DC
Electrical absorption	max 15A
Power rating	450W
Frequency of use	Continue use
Torque	10 - 200 N m
Operating temperature	- 20 + 55 C°
Protection level	IP54
Reductor Type	Irreversible
Opening time	1 ÷ 3 (sec)
Onboard control unit	CTRL/P Digital Controller 36V DC
Encoder	Digital native encoder + magnetic digital SENSORED, 4096 PPR
Accessories power supply	24V DC
Colour	Cabinet: painted RAL9006 arabesque grey - Head: black arabesque silver painted - Boom support: black arabesque silver painted - Boom: painted RAL9010 matt
Release system	European Key cylinder

Batteries recovery	Available (optional)
BUS synchronization Master/Slave	No
Operating cycles per day (opening/closing - 24 hours no stop)	12000 cycles
Maximum dimension product in mm (L x W x H)	380 x 270 x 1237
Product weight packed (Kg)	87,6
Number items per pallet	6

# PRODUCT DIMENSIONS AND PREPARING FOR INSTALLATION

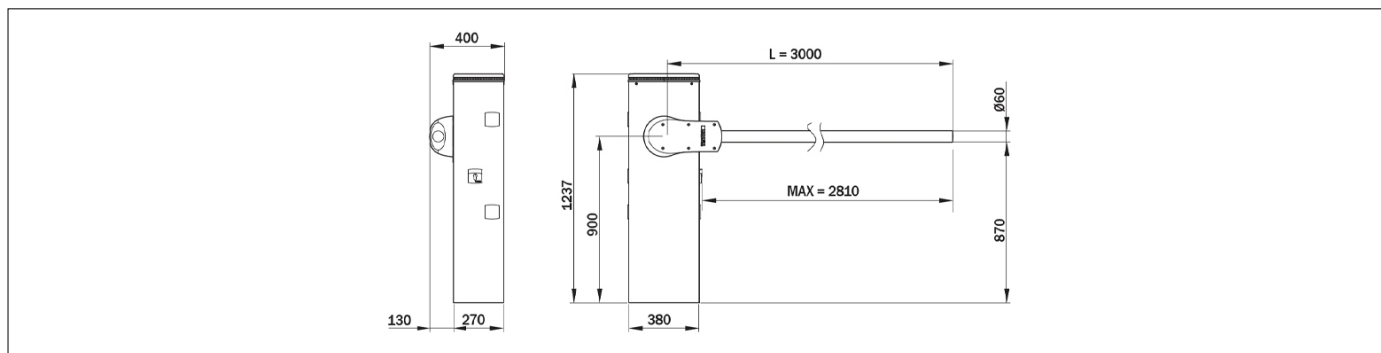

DIMENSIONS

## PRODUCT ACCESSORIES

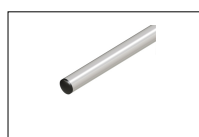

**BA/60/3**  
White painted cylindrical aluminium bar 3 meters length.



**ACS/BA/60**  
Break-away system for barrier, compatible only with BA/60/3 boom arm.



**ACS/BA/68**  
Break-away system for barrier, compatible with BA/68/3 and BA/68/4 boom arm.



**BI/BAT/KIT**  
Kit for emergency batteries charger for brushless digital controller CTRL 36V DC with plug-in card, with 2 recovery batteries 12V DC, 4.5 Ah. Kit for BIONIK barrier.

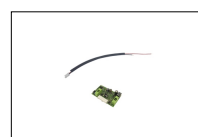

**BI/BCHP**  
Plug-in card, batteries charger, for brushless digital controller CTRL 36V DC, without recovery batteries, for BIONIK barrier.



**BT12V4S**  
Battery 12V 4.5 Ah (1 pc).



**B71/PBX36/BOX**  
Hybrid inverter, "Network Assisted" version, for powering the automation. Also provides a battery-charger function thanks to the connection to the solar panels or mains supply for powering the 36V DC brushless digital controllers with a mains voltage of 230V AC.



**B71/PBX36/BOX/115**  
Hybrid inverter, "Network Assisted" version, for powering the automation. Also provides a battery-charger function thanks to the connection to the solar panels or mains supply for powering the 36V DC brushless digital controllers with a mains voltage of 115V AC.



**B71/PBX/BOX**  
Hybrid inverter, "Full Solar" version, for powering the automation. Also provides a battery-charger function thanks to the connection to the solar panels for powering the brushless digital controllers.

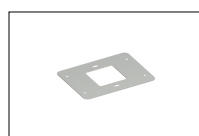

**KT230**  
Fixing plate with stay bolts and screws for BI/001PE - BI/001PC - BI/004HP - BI/006.

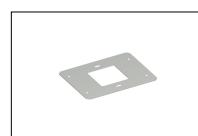

**KT230/IS**  
Fixing plate, inox AISI 304 version, with stay bolts and screws for BI/001PE - BI/001PC - BI/004HP - BI/006.

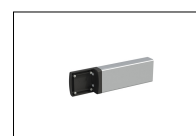

**CRA/BAR**  
Post for photocells G90/F2ES - G90/F4ES - for spaced installation on a barrier cabinet (+23cm).



**CRA/BAR/M90**  
Post for photocells M90/F2ES0 - M90/F4ES0 for spaced installation on a barrier cabinet (+23 cm).



**B73/EXP**  
Signal status board, 2 output for CTRL - CTRL/P



**B74/BCONNECT**  
Module WI-FI B-CONNECT - Remote management and programming system in IP and CLOUD web browser mode via WI-FI hot spot P2P connection for Brushless control units (B70/2ML - EDGE1 - CTRL - CTRL/P - B70/1DCHP).

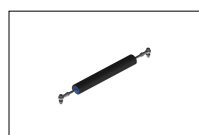

**SP/61/01**  
Spring diameter 61 mm for barriers.



**DLD1/24**  
Loop detector for 1 loop, 2 output, 24V AC/DC.

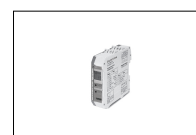

**DLD2/24**  
Loop detector for 2 loop, 2 output + output alarm, 24V AC/DC.

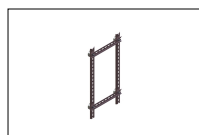

**KT239**  
Kit DIN rail with magnetic support.



**KT242**  
Cable passage kit with magnetic support for barriers.



**BI/BLED/6/RGB**  
RGB LED strip with connection cable for BI/004HP - BI/006 - BI/001PE - BI/001PC barrier header.



**R99/BASB20**  
Pack of 20 stickers for barrier.

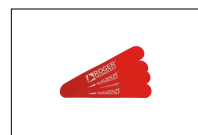

**R99/BASB40**  
Pack of 40 stickers for barrier.